

Bellows suction cups (round)  
**SFB1 40 SI-55 G1/4-AG**



Art.-Nr.: 10.01.06.04421



**Technical data**

Attribute	Value
Suction cup material	Silicone SI
Material hardness [Shore A]	55.0 Shore A
Size	40.00
Material characteristics	FDA-compatible

SFB1 40 SI-55 G1/4-AG

The suction cup SFF / SFB1 (elastomer part + connection nipple) is supplied assembled.

Available spare parts: suction cup SFF / SFB1, connection nipple SC

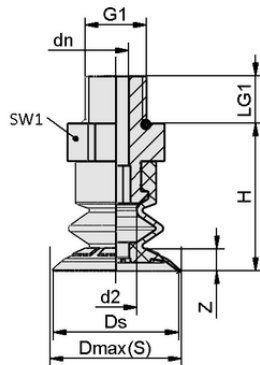

**Design data**

Attribute	Value
Height H	35.70 mm
Nominal diameter dn	4.10 mm
d2	13.7 mm
Thread length LG1	10.0 mm
Key width SW1	17.0 mm
Spring stroke Z	10.0 mm
Diameter Ds	40.0 mm
Diameter Dmax(S)	42.0 mm
Thread G1	G1/4-AG

Design data SFB1 40 SI-55 G1/4-AG



[WWW.SCHMALZ.COM/10.01.06.04421](http://WWW.SCHMALZ.COM/10.01.06.04421)

Bellows suction cups (round)  
**SFB1 40 SI-55 G1/4-AG**



Art.-Nr.: 10.01.06.04421



**Technical data**

Attribute	Value
Suction cup material	Silicone SI
Material hardness [Shore A]	55.0 Shore A
Pull-off force	39.90 N
Suction force (-600mbar)	8.80 N
Weight	18.5 g
Volume	7.500 cm <sup>3</sup>
Size	40.00
Number of folds	1.5
Product family	SFB1

Note: Suction force: The suction force values are theoretical values at -0.6 bar vacuum and a dry, smooth and even workpiece surface – they are specified without safety factors. Hose inner diameter: The recommended hose diameter refers to a hose length of approx. 2 m



**Further documentation**

CAD data and other documents relating to the article can be found at: [www.schmalz.com/10.01.06.04421](http://www.schmalz.com/10.01.06.04421)



**Ordering Data Spare Parts 10.01.06.04421**

Typ		Item number
Bellows suction pad (round)	SFB1 40 SI-55 SC050	10.01.06.04372
Schmalz-Connector	SC 050 G1/4-AG SW410	10.01.06.04347



[WWW.SCHMALZ.COM/10.01.06.04421](http://WWW.SCHMALZ.COM/10.01.06.04421)